



Skirting board Metal Line 87/6 – 88/6



Description

Metal Line 87/6 and 88/6 are recessed skirting boards for brick and plasterboard walls.

Elements of essential design set the tone in the space and instead of limiting it they actually turn the meeting of wall and floor into a feature of aesthetic appeal. Being modular profiles, they are easy to apply and feature a natural aluminium base, pre-drilled to be easily fitted to the brick or plasterboard wall.

The functionality complements the inherent aesthetic quality, expressed through a full range of finishes on solid wood or aluminium listello tile trims, with something to match any type of floor.

As well as their decorative function, these products also fulfil all technical requirements, allowing you to hide the gap at the edge of some floating floors.

Prolight Metal Line 88/I6L/A is an insert for aluminium skirting boards with strip LED lighting system.

If you also add a dimmer (optional) the intensity of the skirting board lighting can be adjusted as a decorative feature or to provide a night light.

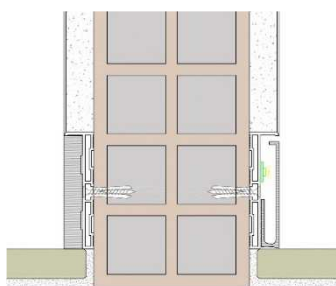

Example skirting board mounted on brick wall, base item no. 87/6 + inserts.

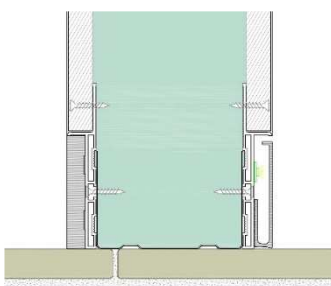

Example skirting board mounted on plasterboard wall, base 88/6 + inserts.

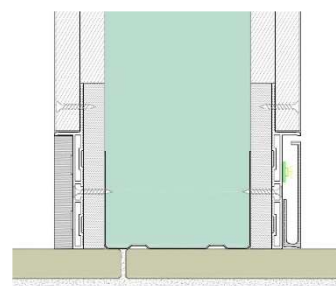

Example skirting board mounted on double sheet plasterboard, base item no. 88/6 + inserts.

Materials

Natural aluminium

Al-Mg-Si aluminium, heat-treated in T6 (6060 T6).

The profiles are made by extrusion.

The outer surface must be protected from scratches and rubbing. They present a strong resistance to chemical and atmospheric agents. When wet, concrete and its derivatives produce alkaline substances which can corrode metal (forming aluminium hydroxide) when allowed to react with the surface. For this reason, the visible surface of the profile must be quickly and delicately cleaned to remove any concrete, adhesive or grouting substances and detergents.

Anodized surfaces can become ruined through wear and foot traffic (profiles used on floors) and the original finish lost as a result.

Anodized aluminium

Al-Mg-Si aluminium, heat-treated in T6 (6060 T6).

The profiles are made by extrusion then anodized with a $\geq 15 \mu\text{m}$ thick layer.

The outer surface must be protected from scratches and rubbing. They present a strong resistance to chemical and atmospheric agents. When wet, concrete and its derivatives produce alkaline substances which can corrode metal (forming aluminium hydroxide) when allowed to react with the surface. For this reason, the visible surface of the profile must be quickly and delicately cleaned to remove any concrete, adhesive or grouting substances and detergents.

Anodized surfaces can become ruined through wear and foot traffic (profiles used on floors) and the original finish lost as a result.

Coated aluminium

Al-Mg-Si aluminium, heat-treated in T6 (6060 T6).

The profiles are extruded and then coated. They present a good resistance to chemical and atmospheric agents but not to mechanical stress which damages the surface coating. This means they are not recommended for floor use. Concrete, adhesive, grouting materials and detergents must be immediately removed from the visible surface of the profile.

General note on metals

Aluminium is not resistant to all chemical compounds. Consequently, contact with particularly aggressive products like hydrochloric acid (HCl) and phosphoric acid (H3PO4) should be avoided.

Products generally used to clean stone, ceramic and porcelain tiles, such as muriatic acid, ammonia and bleach, damage the surface finish on the metal and can cause intense corrosion. Moreover, any residues of concrete, adhesive, detergents and grouting materials must always be removed as quickly and delicately as possible from the surface of the profiles.

If adhesive tape is used to cover the profile, it must not be left any longer than an hour.

Fixing

Fixing with PP/96 type adhesive or with screws and plugs.

Remove the skirting board profiles (base and insert) from the package.

Where present, also remove any protection (protective and/or shrink-wrapped film) added to protect the finish.

Measure the length required and cut the skirting board profiles (base and insert) to this length using an appropriate tool.

Fixing to brick wall

- Fix using suitable adhesives (such as PP/96)

Place the skirting board base profile, cut to the right length, in position and fix it to the support with the adhesive, making sure that the support is free of dirt and perfectly clean. Press and hold evenly along the length of the skirting board base profile for a few minutes to make sure it bonds correctly with the laying surface; any excess adhesive must be removed so that it is not still visible on completion.

- screw-fixing

Place the skirting board base profile, cut to the right length, in position and use a permanent marker to mark the exact position of the holes on the base profile, where holes should be drilled. Remove the base profile and drill holes in the wall, in the positions that you marked previously, being careful to check the exact size of the plugs needed. Slot the plugs into the holes drilled in the wall; reposition the profile correctly and fix it to the wall using the right type of screws, making sure that the support surface is perfectly clean.

Apply plaster coating to the wall, being careful to protect the visible part of the skirting board.

Fixing to plasterboard walls

- Place the skirting board base profile, cut to length, in the correct position; fix with suitable self-tapping screws to the plasterboard stud frame before assembling the plasterboard panels, making sure the area where the profile is to be attached is perfectly clean.

Fixing insert profile

Before attaching the insert, thoroughly clean the area to which it will be fixed.

Place the insert, cut to length, in the skirting board cavity, fixing it with a thin layer of a suitable adhesive (such as PP/96) or using the adhesive already present on the insert.

Press and hold evenly along the length of the insert to make sure it bonds correctly to the surface of the skirting board.

Any excess adhesive must be removed so that it doesn't show on completion.

Insert 88/I6L/A should only be secured after the strip LED lights have been put in position; the profile already has an adhesive strip for fixing.

For the choice and assembly of electrical components (strip LED lights, power units, etc....) see LED strip light technical data sheet.

The electrical installation and start-up should only be done by trained personnel.

The external corner, item no. 88/6E, should be positioned and fixed only after the base profile had been secured, and must be suitably protected before grouting/levelling the upper edge to avoid ruining it.

Care and maintenance

Care and maintenance procedures for the materials used to make these profiles depends largely on the type of alloy and/or finish used. The instructions provided below describe the operations to be performed on the profile to restore it as much as possible to its original condition. The purpose of this document is to provide as many general indications as possible to guide you on when and how to clean the product, but they should also be verified on a case-by-case basis. It should be pointed out that there are specific responsibilities in each part of the product's life cycle, starting from when it is installed the first time.

Aluminium

No special maintenance is required and aluminium products can be easily treated with colourless alcohol in a water solution or using ordinary detergents, provided they do not contain acid (hydrochloric or hydrofluoric). Detergent products made by multiple manufacturers and sold under a variety of commercial brands can generally be used for cleaning.

Generally speaking, there are three types of products:

- Alkaline
- Neutral
- Acid

For cleaning purposes, we recommend using a neutral detergent diluted in water then rinsing with water only, using a non-abrasive sponge and/or cloth to avoid scratching and/or damaging the anodized surface.

During cleaning, the following aspects must be kept in mind at all times:

- Do not use acid or alkaline detergents because they could damage the aluminium;
- Do not use products and/or abrasive materials;
- Do not use organic solvents on painted surfaces;
- Do not use detergents without first checking their chemical composition;
- Do not apply detergents straight onto the surface to be cleaned;
- Surfaces must be "cold" (max T°= 30°C) during cleaning and not exposed to direct sunlight;
- Detergents used in cleaning must also be "cold" (max T° = 30°C) and steam sprays should not be used.

In any case, the final stage in the cleaning process is always sufficient rinsing of the parts treated with water. They must then be immediately dried using cloths or soft leather. Polishes or similar products are not required.

Clean profiles carefully as soon as required, following the instructions on the product package, to prevent any residues of concrete, grout or similar substances from attacking the surface.

Fire prevention measures

In the event of fire, use chemical fire extinguishers, dry sand or solid extinguishing agents.

Notes:

These profiles must be handled with caution, being careful to wear suitable gloves to prevent injury and/or cuts to the hands.

The instructions and specifications provided here are the product of our experience but are only a guide, should not be considered exhaustive and must be confirmed by extensive practical applications.

Profilpas declines any responsibility for damage to people or things resulting from improper use of the product.

Users must establish for themselves if the product is suitable for the required used and they bear full responsibility for any incorrect installation of the material.

Metal Line 87/6 – 88/6

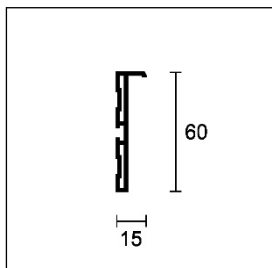

87/6

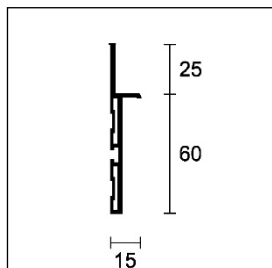

88/6

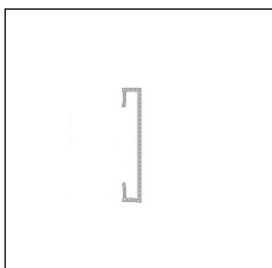

88/I6SF

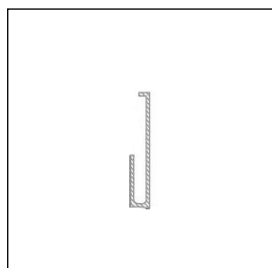

88/I6L/A (adhesive)

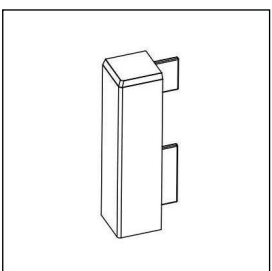

88/6E

Metal Line 87/6 – 88/6

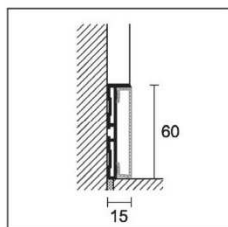

87/6 + 88/16SF
aluminium insert

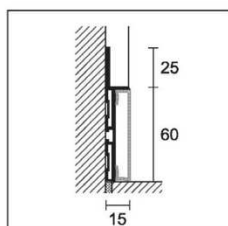

88/6 + 88/16SF
aluminium insert

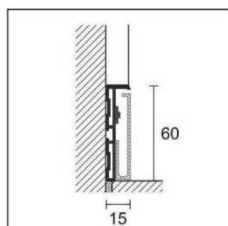

87/6 + 88/16L/A
aluminium insert for
LED light

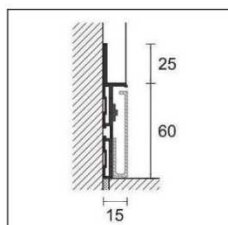

88/6 + 88/16L/A
aluminium insert for
LED light

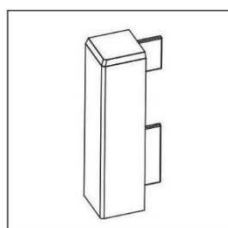

88/6E

For the best aesthetic result and the validity of the warranty, we suggest the exclusive use of our electrical components.

METAL LINE 87 E 88

length = 200 cm - pack 20 pcs

H cm

ART. finishing

6

ALUMINIUM

87/6 natural aluminium (drilled)

78338

88/6 natural aluminium (drilled)

78310

individually packed

ALUMINIUM INSERT

length = 200 cm - pack 20 pcs

H cm

ART. finishing

6

88/16SF silver anodised

78563

88/16SF matt white RAL 9010
colour-coated

78558

individually packed

ALUMINIUM INSERT FOR LED LIGHT

length = 200 cm - pack 20 pcs

H cm

88/16L/A silver anodised

78559

88/16L/A matt white RAL 9010
colour-coated

78560

adhesive - individually packed
 for electrical components, see page 59

METAL OUTSIDE CORNER

pack 4 pcs

H cm

ART. finishing

6

88/6E silver

78561

88/6E matt white RAL 9010
colour-coated

78562

no partial packaging



88/6 natural aluminium + 88/16SF matt white aluminium insert